

03245

RP

PEARL MILLET IMPROVEMENT PROGRAM

ICRISAT-TNAU COOPERATIVE NURSERY

DHAYANISABAR

FIELD PLANS

KHARIF 1985

ICRISAT

International Crops Research Institute for the Semi-Arid Tropics

ICRISAT Patancheru P.O.

Andhra Pradesh 502 324, India

PEARL MILLET IMPROVEMENT PROGRAM

FIELD PLANS: KHARIF 1985

CONTENTS

	Page No.
NB 2	2
NB 4	4
NB 4A	6
NB 5	8
NB 6/7 (I)	10
NB 6/7 (II)	12
NB 8	14
NB 9	16
NB 10	18
NC 1	20
NC2 & 3	22
NC 4	24
NC 6	26
NC 7	28
NC 8	30
NC 8A	32
NC 8B	34
NC 9	36
NC 9A	38
NC 11	40
NC 12	42
NC 13	44
NC 14	46
NC 15	48
NC 16	50
NC 16A	52
ND 10	54
NE 20	56
NE 25	58

Pearl Millet Breeding

NB 2

Planted: June 15

N-brd-1

1 NELC (S₁) progeny trial

520x1(2m)x2

N-brd-5

2 Testcross nursery I (part)

108x1x1

NB 2

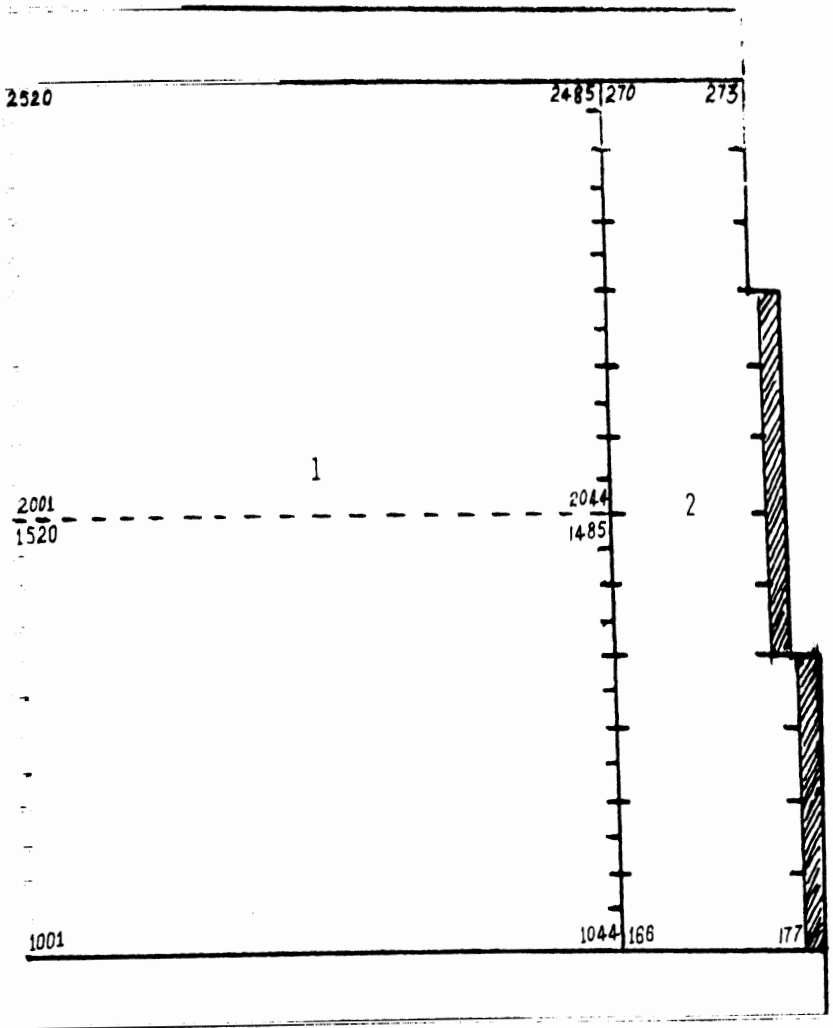

Pearl Millet Breeding	MB 4	Planted: June 15
M-brd-5		
1	Testcross nursery II (cont.)	106x1x1
M-brd-GRU-1		
2	Togo-Ghana accessions	30x1x1
M-brd-10		
3	Seed parents (F ₈) progenies (part)	56x1x1
M-brd-3		
4	Testcrosses	50x1x1

NB 4

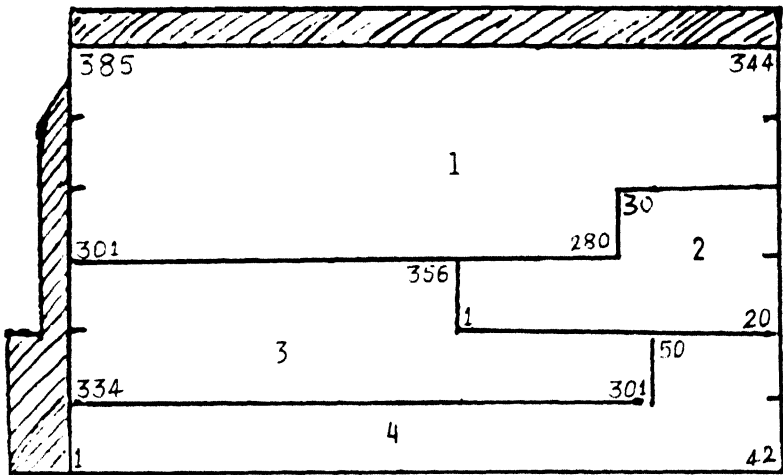

Pearl Millet Breeding

MB 4A

Planted: June 15

M-3rd-5

1 Testcross nursery II (cont'd)

128x1x1

NC 4A

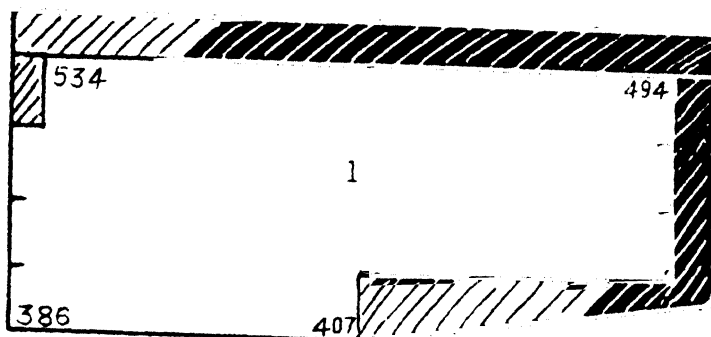

Pearl Millet Breeding

MB 5

Planted: June 14

M-bred-10

1 Seed parents (F₅) progenies

1071x1 (2m)x1

NB 5

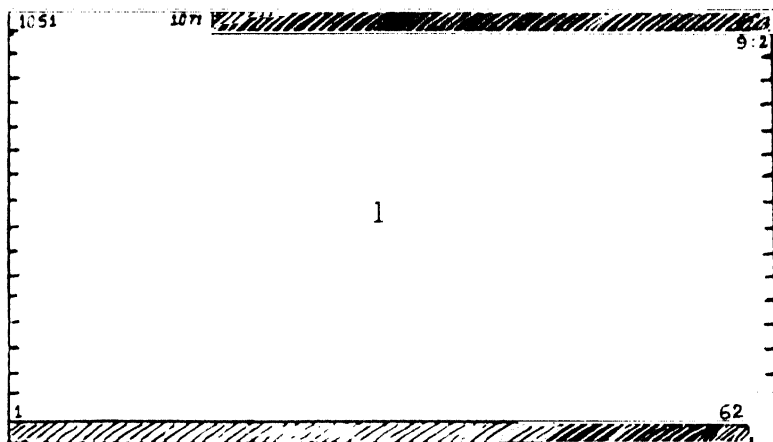

Pearl Millet Breeding

MB 6/7(I)

Planted: June 13

M-brd-4

1 Diallel topcross trial

108x2x2

M-brd-5

2 Testcross nursery I (part)

165x1x1

NB 6/7 (1)

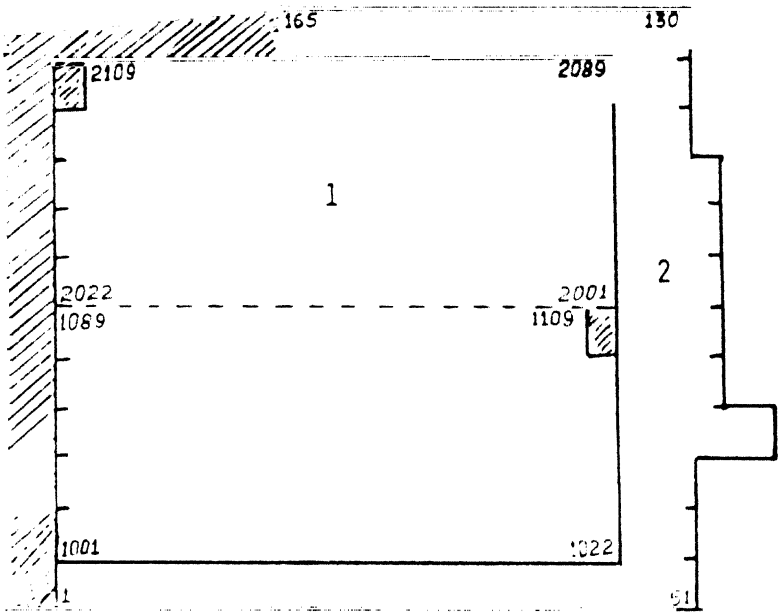

Pearl Millet Breeding

MS 6/7 (II)

Planted: June 13

~~M-brd-4~~

1 ICMS 7703 bulks trial

25x4x2

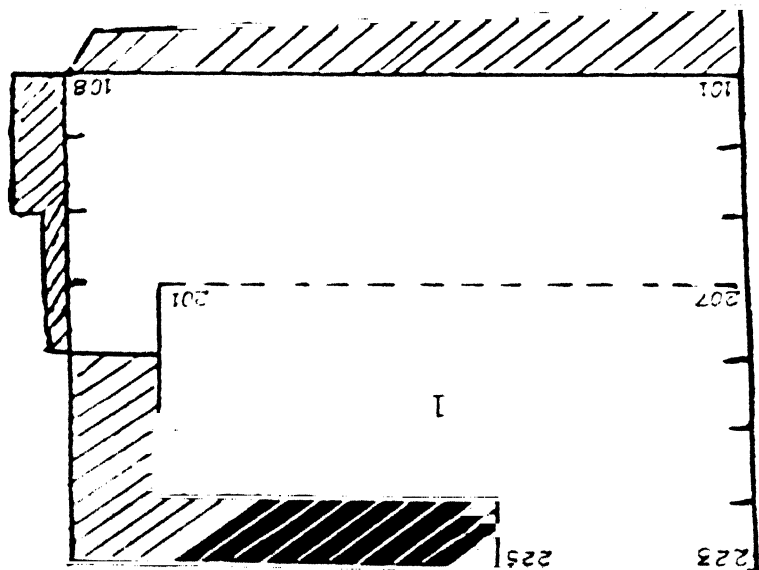

NB 677 (II)

Pearl Millet Breeding

MB 8

Planted: June 13

~~N-brd-4~~

1 Testcross nursery I (part)

388x1x1

NR 4

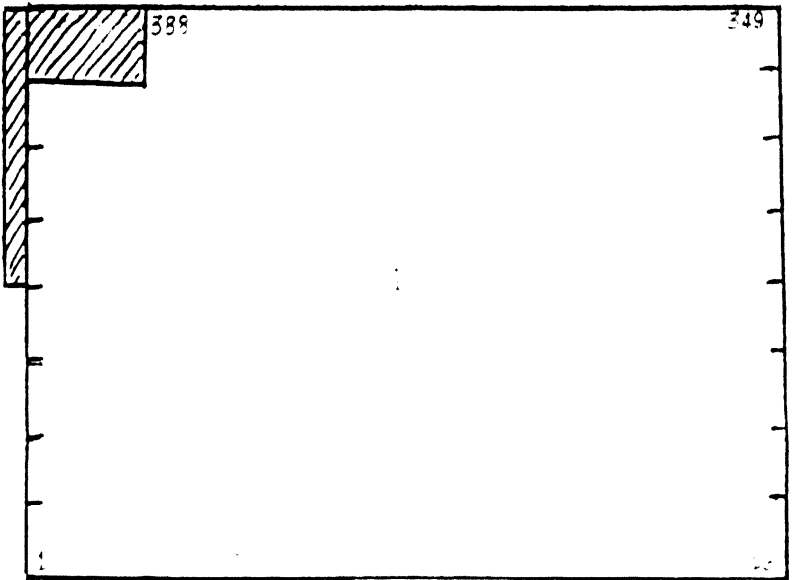

Pearl Millet Breeding

MB 9

Planted: June 13

M-brd-1

1 Bunt Resistant Composite
(8₁) progeny trial

420x1 (2m)x2

NB 9

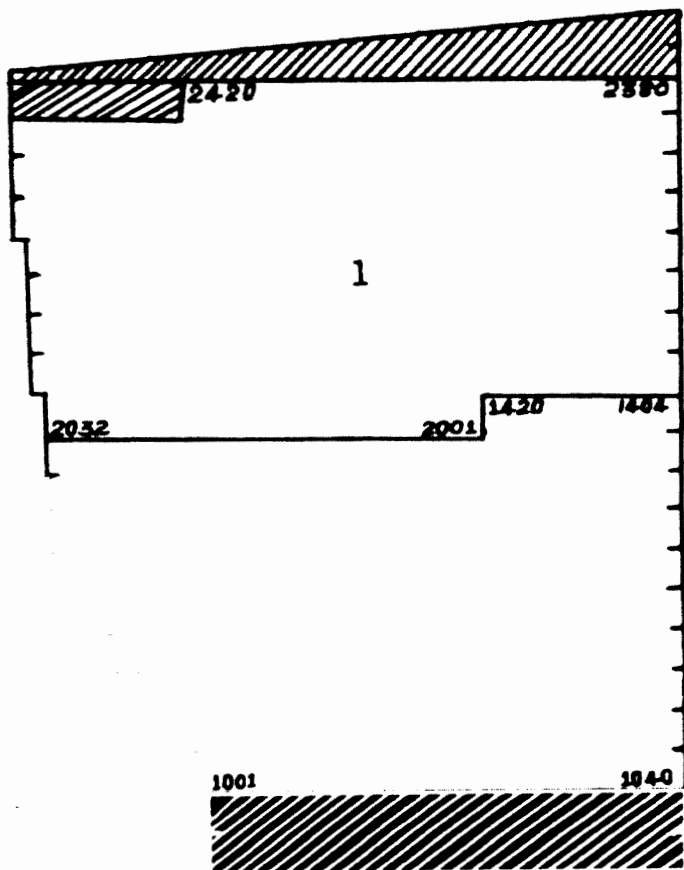

Pearl Millet Breeding NB 10 Planted: June 11

~~M-brd-gru-1~~

1 Photosensitive excursions 8x11x1

~~M-brd-1~~

2 Medium composite (S₁) progeny trial 450x1 (2m)x2

NB 10

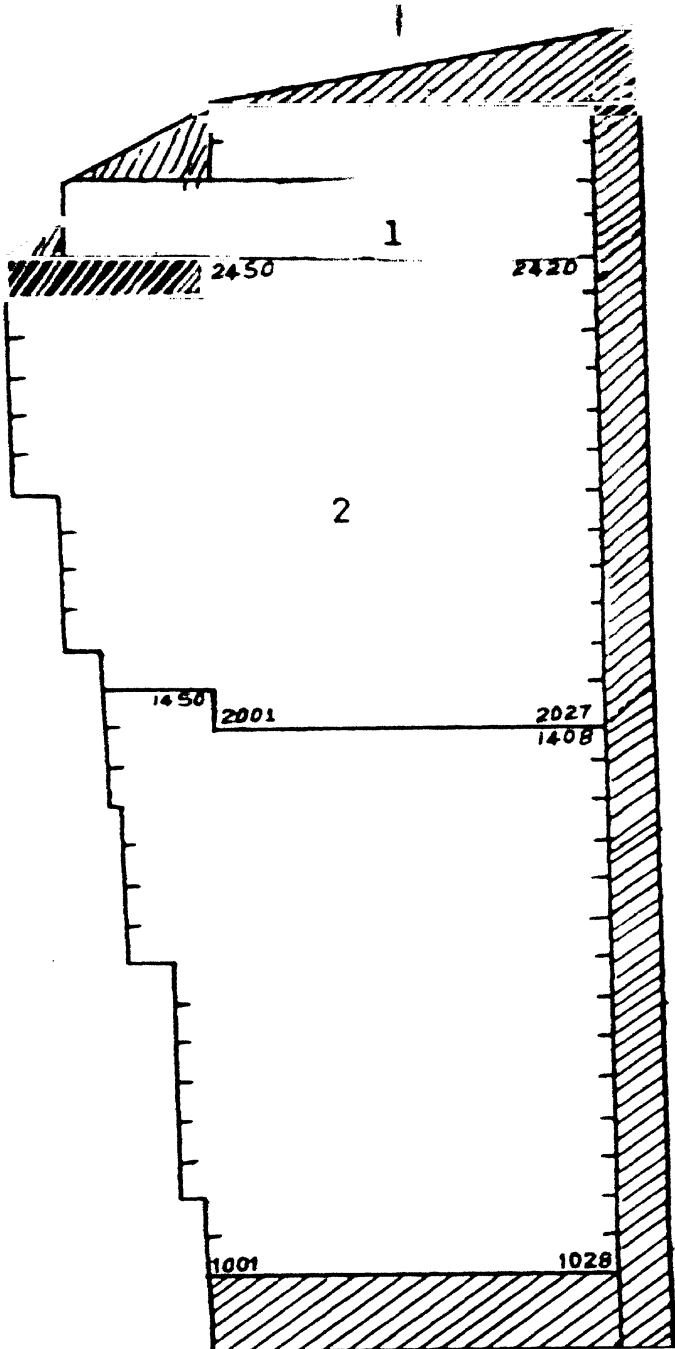

Pearl Millet Breeding

NC 1

Planted: June 10

~~M-brd-5~~

1 Testcross nursery-III

328x1 (2m)x1

~~M-brd-8~~

2 Testcross nursery

320x1 (2m)x1

3 F₈ progenies

317x1 (2m)x1

NC 1

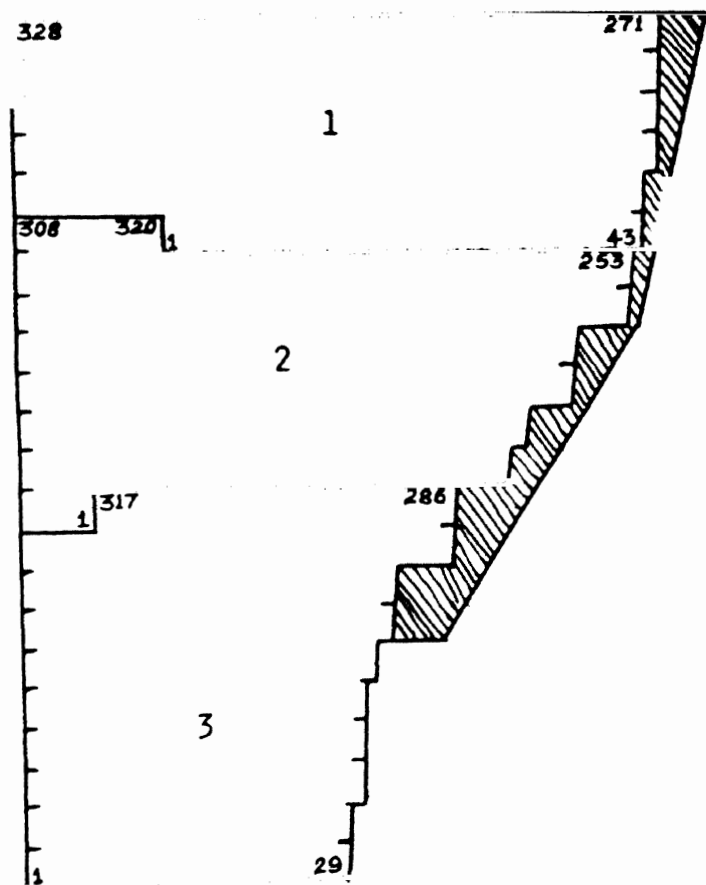

Pearl Millet Breeding EC 2 & 3 Planted: June 7

N-brd-4

- | | | |
|---|--------------------|---------|
| 1 | Inbred nursery | 100x1x1 |
| 2 | Pre-Inbred nursery | 324x1x1 |

N-brd-8

- | | | |
|---|-------------------------|---------|
| 3 | Uniform progeny nursery | 100x1x1 |
|---|-------------------------|---------|

N-brd-5

- | | | |
|---|--------------------------------------|--------|
| 4 | Pearl Millet Advanced Hybrid Trial-1 | 48x4x4 |
|---|--------------------------------------|--------|

N-brd-1&4

- | | | |
|---|---------------------------------------|--------|
| 5 | Pearl Millet Advanced Varieties Trial | 48x4x4 |
|---|---------------------------------------|--------|

Pearl Millet Breeding

NC 4

Planted: June 8

N-brd-5

1 Hybrid parents trial

21x4x3

Pearl Millet Breeding

NC 6

Planted: June 8

M-brd-1

1 Composite bulks trial

49x4x3

M-brd-8

2 Testcross nursery

50x1x1

M-brd-10

3 Seed parents F₇'s

80x1x1

4 Male sterile lines trial

18x1x2

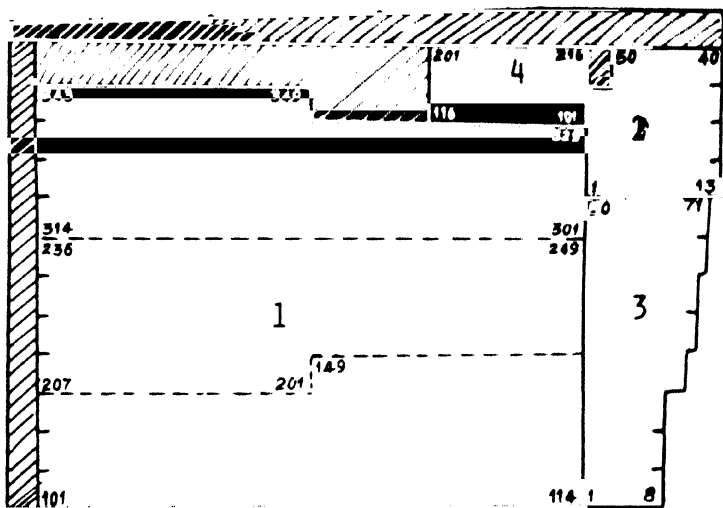

Pearl Millet Breeding

NC 7

Planted: June 8

M-brd-1

- | | | |
|---|------------------------------------|--------|
| 1 | Population diallel trial | 18x4x4 |
| 2 | Initial population varieties trial | 38x4x3 |

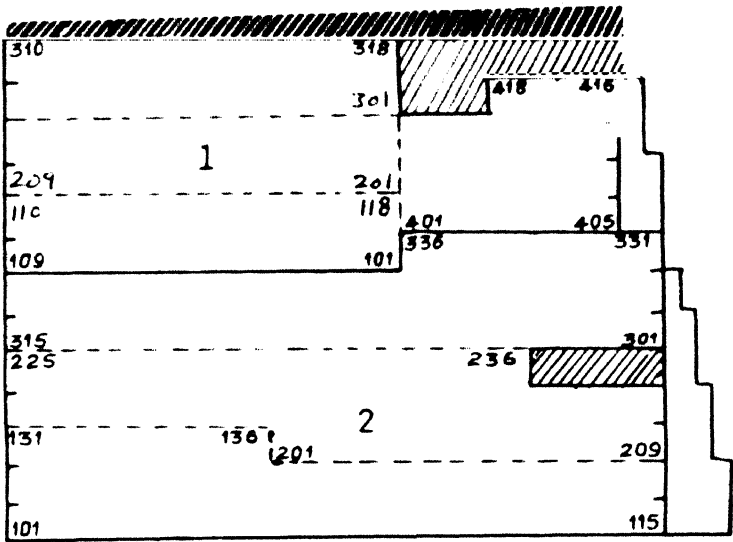

Pearl Millet Breeding NC 8 Planted: June 8

N-brd-10

1 Seed parents (F_2) progenies (part) 128x1x1

N-brd-4

2 Pearl millet initial synthetic trial-II 25x4x3

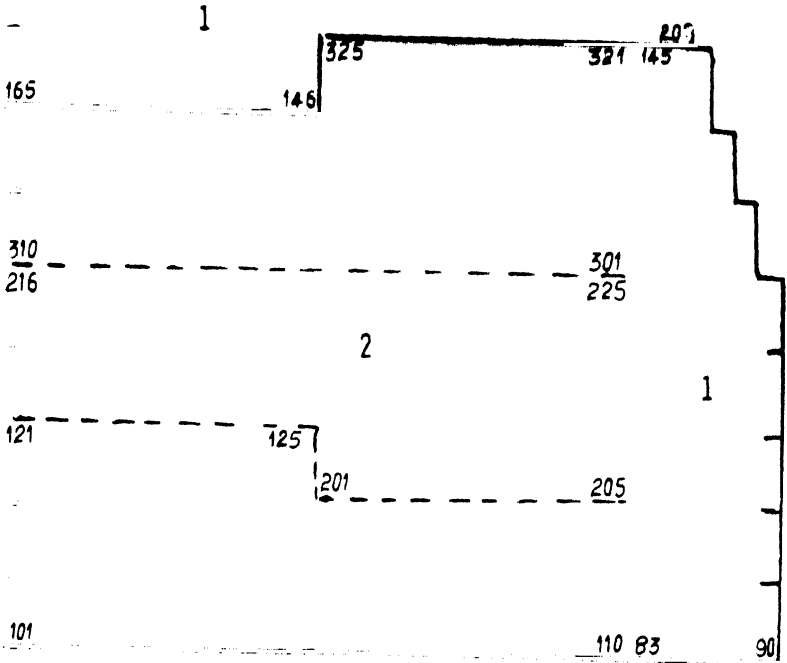

Pearl Millet Breeding

NC 8A

Planted: June 9

M-brd-10

1 Seed parents (F_8) progenies (part)

32x1x1

M-brd-4

2 85-Series synthetic trial

32x2x2

	1	
300		269
232		217
	2	
101		116

Pearl Millet Breeding

NC 88

Planted: June 9

M-brd-5

1 Testcross trial (medium dwarf)

81x1x2

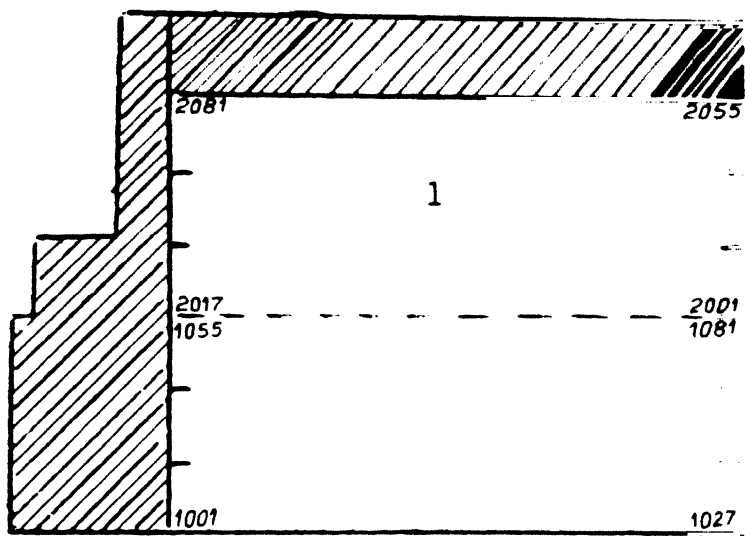

Pearl Millet Breeding MC 9 Planted: June 9

M-brd-10

1 Seed parents (F₈) progenies (part) 60x1x1

M-brd-4

2 Pearl millet initial synthetic trial-1 25x4x3

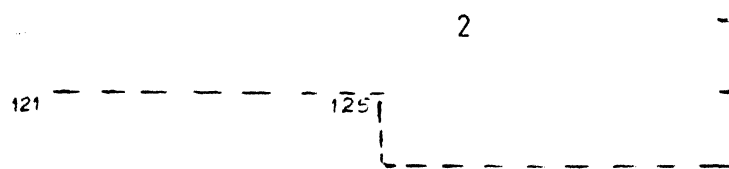
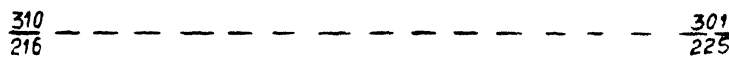
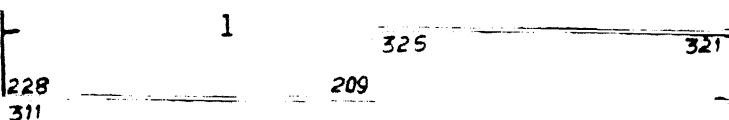

Pearl Millet Breeding

NC 8A

Planted: June 8

M-brd-5

1 Early maturity testcross trial

144x1x2

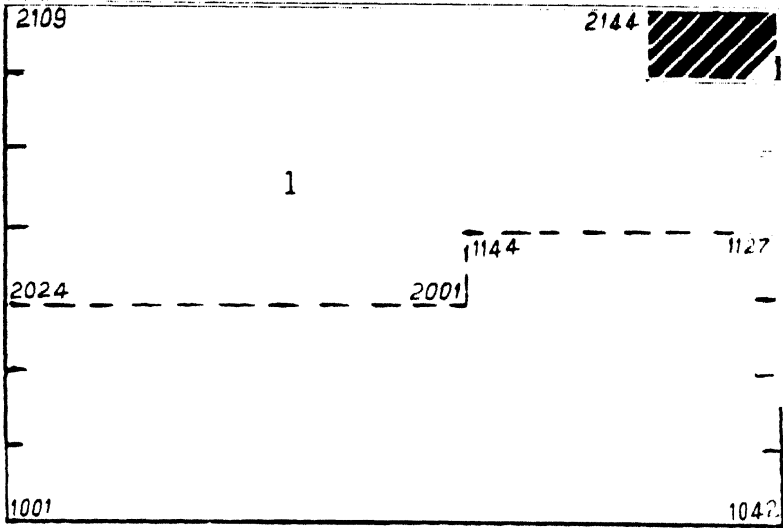

Pearl Millet Breeding

NC 11

Planted: June 8

~~R-brd-8~~

1 International Pearl Millet Adaptation Trial

21x8x3

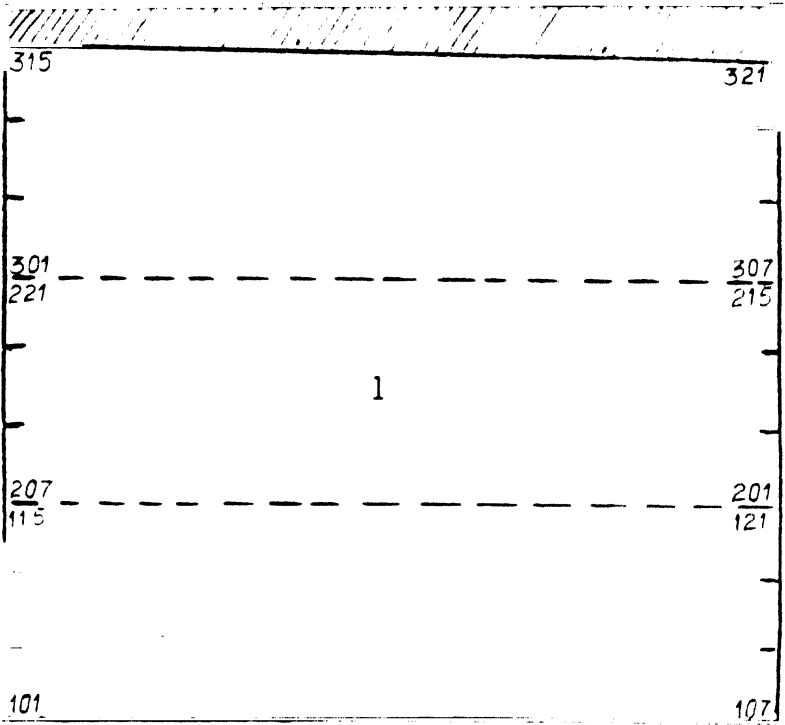

Pearl Millet Breeding

MC 12

Planted: June 8

M-brd-10

- | | | |
|---|---|--------|
| 1 | Seed parents (F_8) progenies (part) | 80x1x1 |
| 2 | ExBornu (d_2) bulk | |

M-brd-1

- | | | |
|---|---|--------|
| 3 | Initial pearl millet specific varieties trial | 25x4x3 |
|---|---|--------|

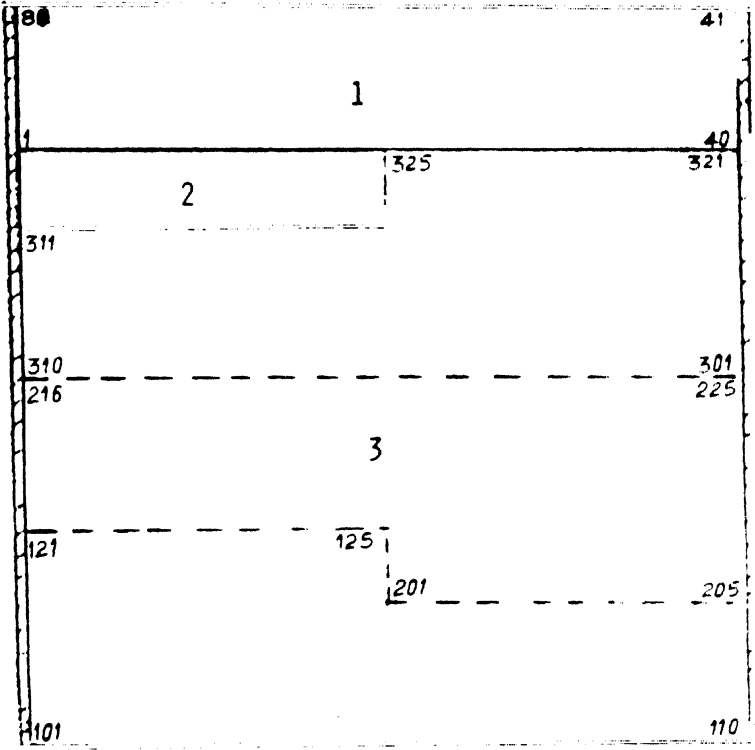

Pearl Millet Breeding

NC 13

Planted: June 23

~~M-brd-10~~

1 A/B lines

~~M-brd-5~~

2 Pearl Millet Initial Hybrid Trial

144x2x3

3 F₅ progenies

120x1x1

~~M-brd-gru-1~~

4 88A hybrids

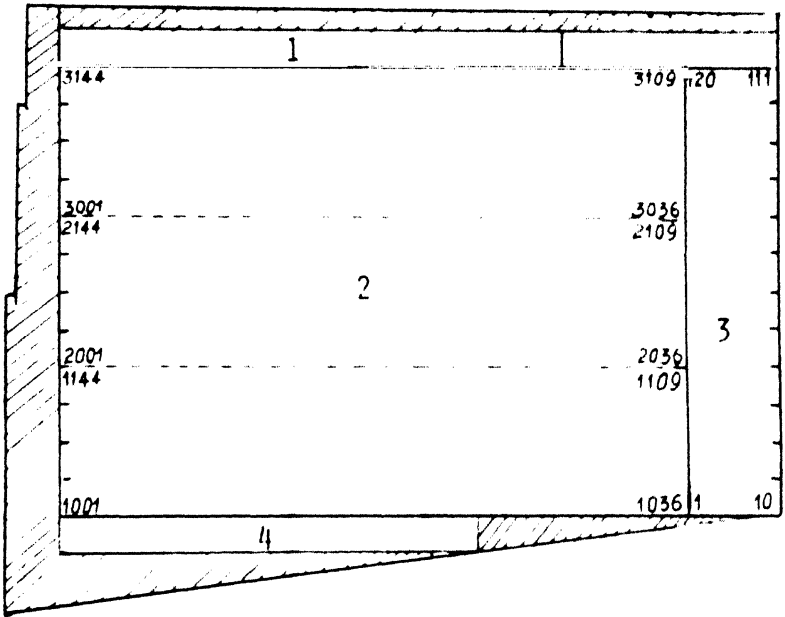

Pearl Millet Breeding

NC 14

Planted: June 23

M-brd-5

1 F₅ progenies (part)

80x1x1

M-brd-4

2 Pre-Uniform progeny nursery

272x1x1

NC 14

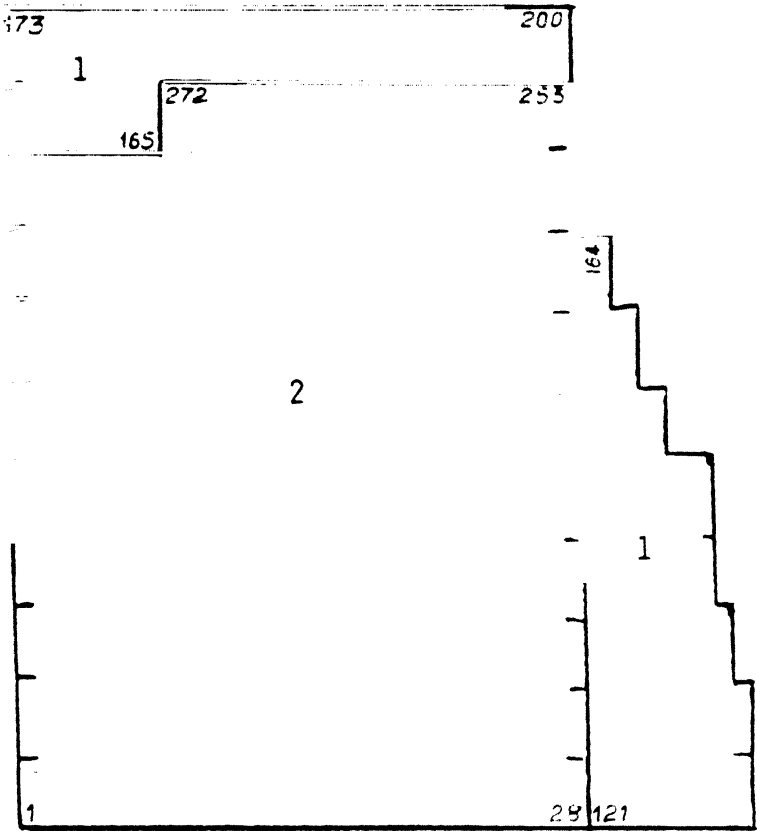

Pearl Millet Breeding

NC 15

Planted: June 23

M-brd-5

1 F₅ progenies (part)

56x1x1

M-brd-3

2 Ghana progenies trial

44x2x3

M-brd-1

3 Smut Resistant Composite Bulks Trial

12x4x4

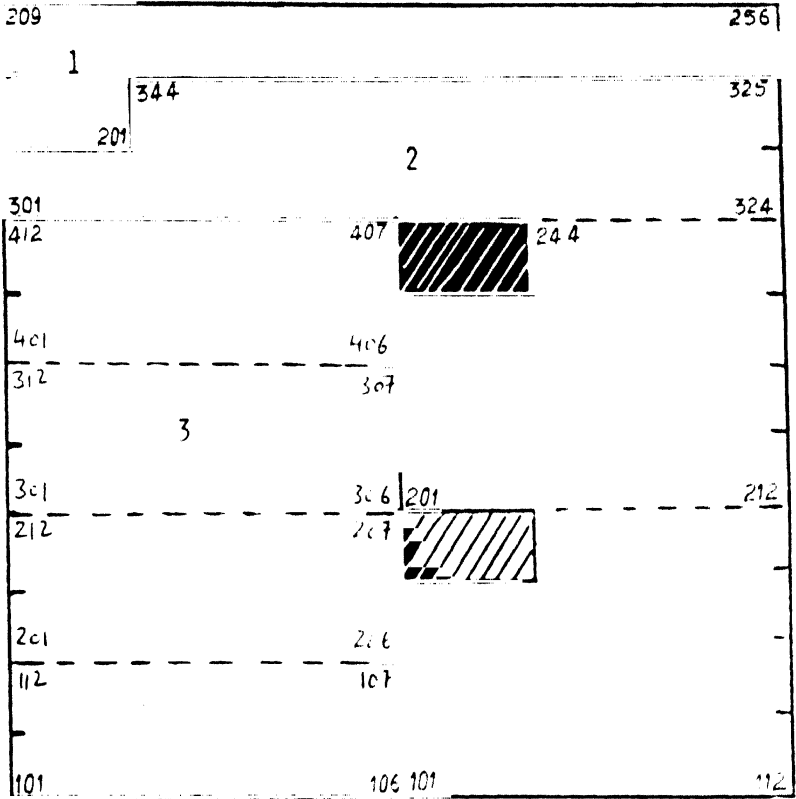

Pearl Millet Breeding

NC 18

Planted: July 5

H-brd-5

1 Testcross trial (medium height/maturity)

225x1x2

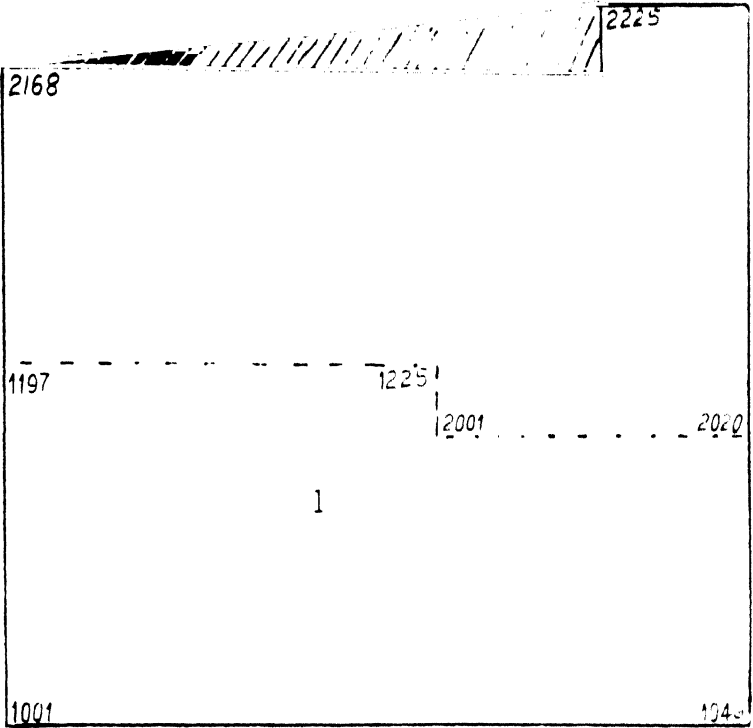

Pearl Millet Breeding

MC 18A

Planted: July 5

~~M-brd-5~~

1 Testcross trial (early dwarf)

144x1x2

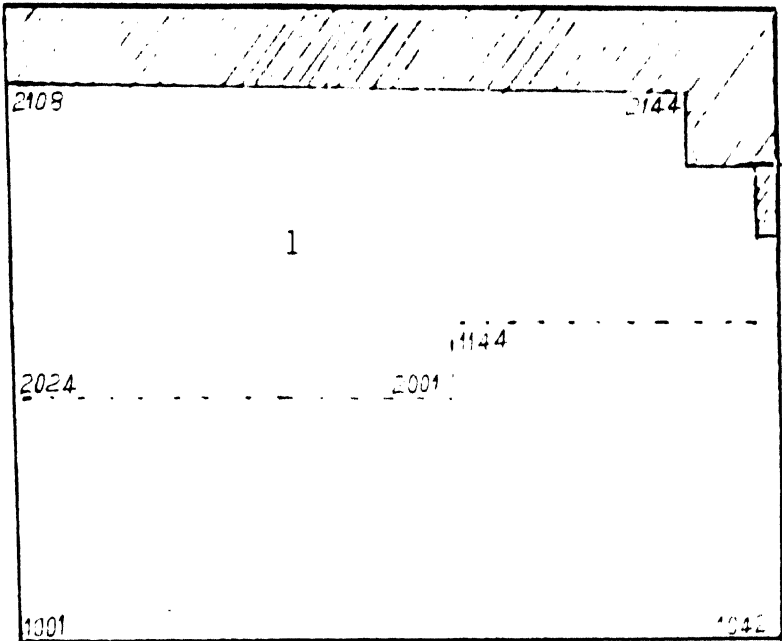

Pearl Millet Breeding

MD 10

Planted: June 10

M-brd-3

1 Dwarf sidcars - isogenic inbred lines trial 24x4x4

M-brd-5

2 Pearl Millet Advanced Hybrid Trial-2 49x2x3

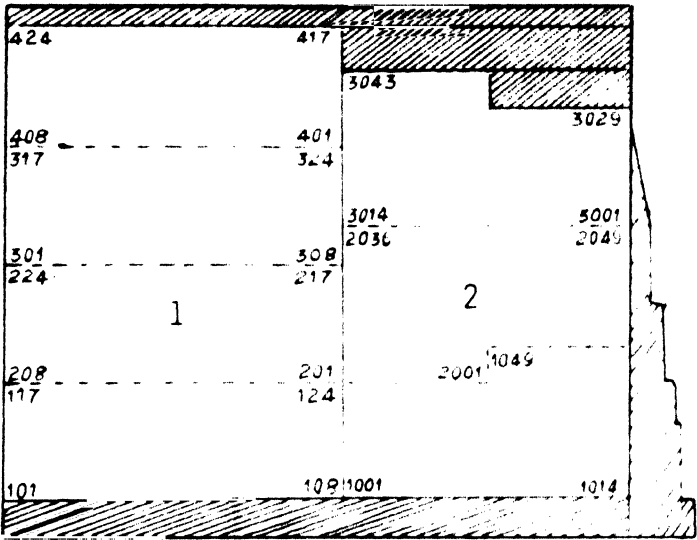

Pearl Millet Breeding

NE 20

Planted: June 29

M-brd-4

- | | | |
|---|---------------------------|--------|
| 1 | 84-series synthetic trial | 45x4x4 |
| 2 | Diallel trial-4 | 45x2x2 |

M-brd-3

- | | | |
|---|--------------------------|---------|
| 3 | Preliminary hybrid trial | 400x1x2 |
|---|--------------------------|---------|

M-brd-11

- | | | |
|---|------------------------------------|---------|
| 4 | Pollinator collection hybrid trial | 256x1x2 |
|---|------------------------------------|---------|

NE 20

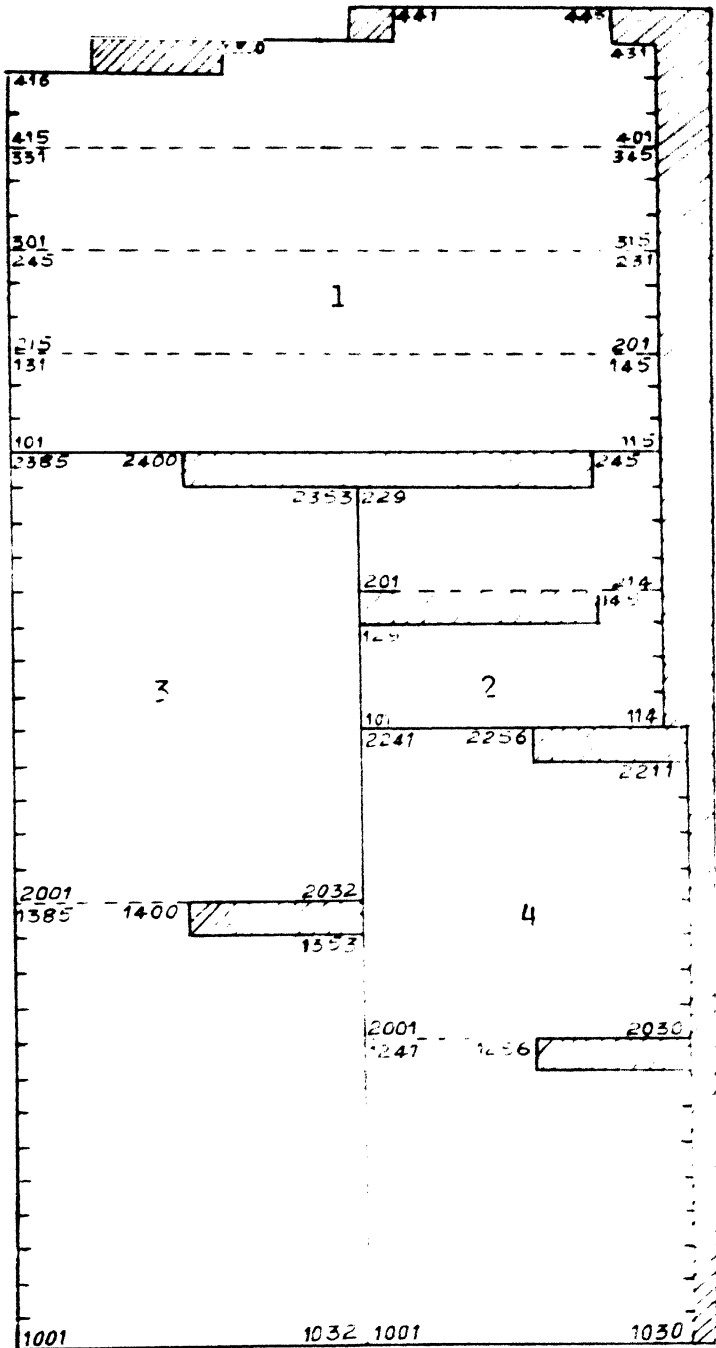

03!

-58-

Cereal Microbiology

ME 25

Planted: June 14

- | | | |
|---|--------------------------------|--------------------------------|
| 1 | Pearl millet inoculation trial | 4 genotype x 4 treatment x 6x4 |
| 2 | Sorghum inoculation trial | 3 genotype x 4 treatment x 6x4 |

